

LATITUDE - 22°36'0.60"N
 LONGITUDE - 88°23'51.56"E

LATITUDE - 22°35'59.12"N
 LONGITUDE - 88°23'55.00"E

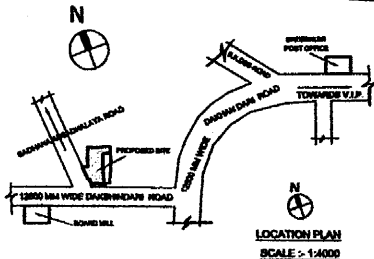
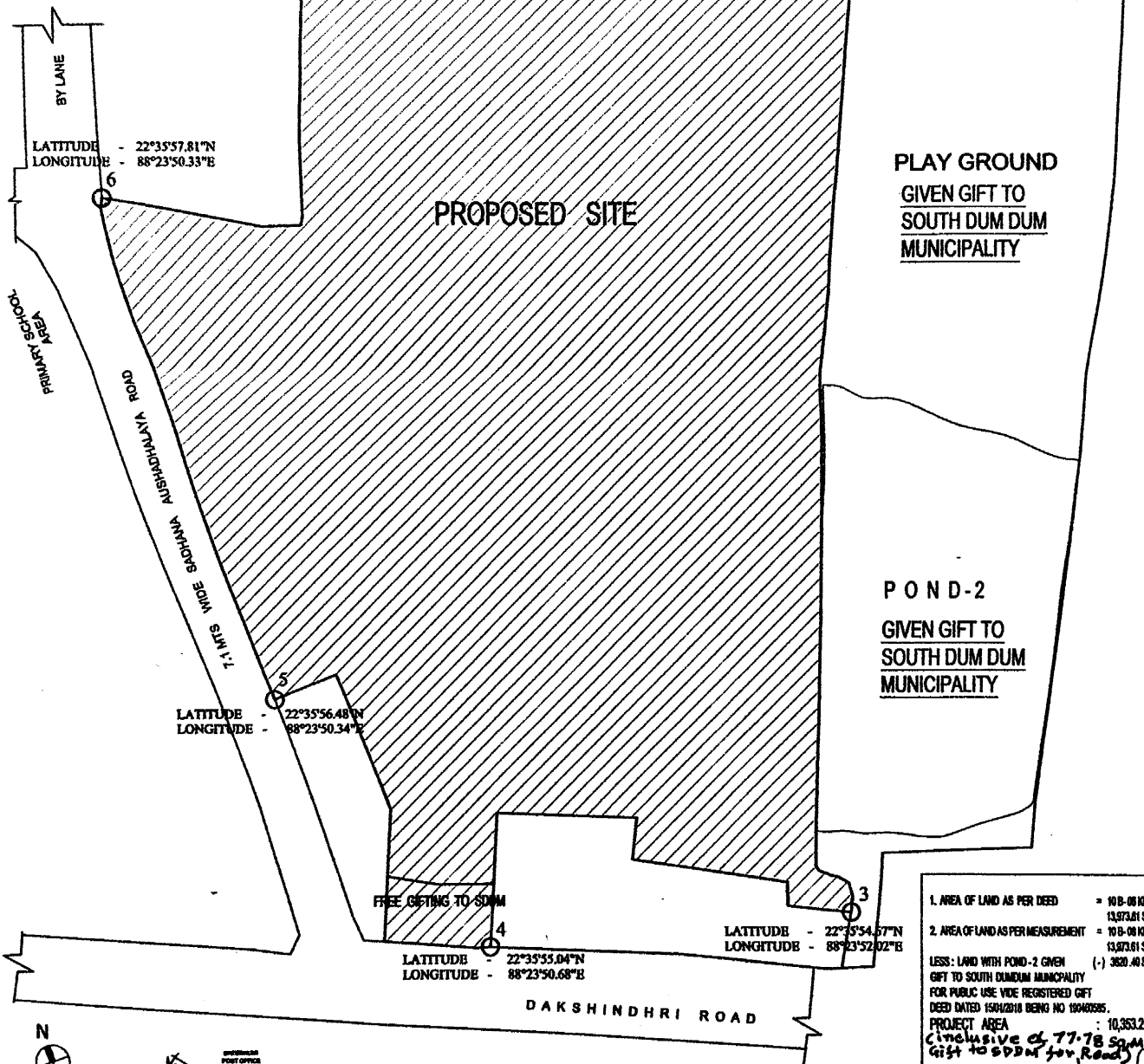

FREE GIFTING TO SDDM

LATITUDE - 22°35'53.04"N
 LONGITUDE - 88°23'50.68"E

LATITUDE - 22°35'54.67"N
 LONGITUDE - 88°23'52.02"E

1. AREA OF LAND AS PER DEED	= 10 B-08 104-13 CH-11 SFT. 13,973.61 SQ.M.
2. AREA OF LAND AS PER MEASUREMENT	= 10 B-08 104-13 CH-11 SFT. 13,973.61 SQ.M.
LESS: LAND WITH POND-2 GIVEN GIFT TO SOUTH DUMDUM MUNICIPALITY FOR PUBLIC USE VIDE REGISTERED GFT DEED DATED 15/01/2010 BEING NO 150402085.	(-) 3620.40 SQ.M.
PROJECT AREA	: 10,353.21 SQ.M.
C inclusive of 77.78 SQ.M. land Gift to SDDM for Road	

Prabhat Machhar
PRABHAT MACHHAR
 CA/2008/42983

SIGNATURE OF ARCHITECT
 ARCHITECTS
PRABHAT DESIGN STUDIO
 P. NO. 107, FLOOR, SECTOR A, METROPOLITAN
 TOLLGATE - 700105
 SCALE - 1:500 (A3)

TITLE -
SITE PLAN WITH COORDINATES
 PROJECT -
 SITE PLAN OF PREMISES AT HOLDING NO.-116, DAKSHINDHRI ROAD, WARD-33, P.S.DAG NO.-1108, 1109, 1108, 1170, 1171, 1172, 1173, 1174/801, KHATIAN NO: (N) 750, 751, 749, 745, 746, 748, 747, 744, 753, 755, 756, 754, 752, 741, 740, 738, 742, 743, 757, 758, (O)780, 781, TOLZI NO.- 1283/2833, MOUZA - PANCHANNA GRAM, DIST.-24 PGS (N) UNDER S.D.D.M. P.S.- LAKE TOWN.